

# FLOAT OPERATED, MINI LEVEL SWITCHES - "MFGS"



SINCE 1984

**MINI LEVEL SWITCHES -'MFGS'** : Are installed vertically and can be side mounted through an elbow. They provide actuation high, low or intermediate liquid levels. The switch actions can be reversed from N/O to N/C & vice versa by simply changing the float direction.

**APPLICATIONS :**

Hot Water / Coffee Servers, Vending Machines, Ice Makers, Humidifiers, Food Industry, Air Conditioning & Refrigeration, Analysers, Engines, Agricultural Machines, Hydraulic, Lubricating & Oil Filtration Equipment's, Industrial Working Machines, Spark Erosion Machines & SPMs.

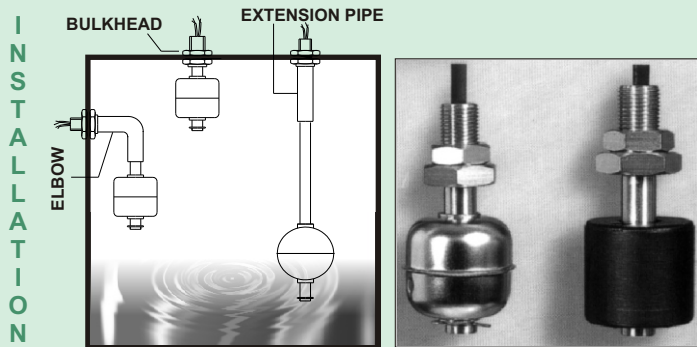

## MFGS

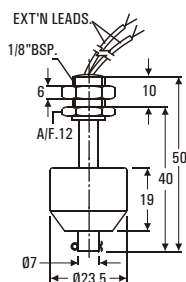

**MODEL No.** : MFGS-Y21  
**FLOAT MATERIAL** : NYLON(SOLID)  
**FLOAT SIZE** : Ø23.5x19mm.  
**GUIDE TUBE MATERIAL** : BRASS  
**PROCESS CONN.** : 1/8" BSP. with lock nut  
**SWITCH CAPACITY** : 10VA or 40VA(N/O)  
**SWITCHING VOLTAGE** : 240VAC/200VDC  
**SWITCHING CURRENT** : 2A  
**CARRY CURRENT** : 3A  
**TERMINATION** : PVCx300mm.extn leads  
**SWITCH ACTION** : REVERSIBLE  
**MAX. TEST PRESSURE** : 1Kg/cm2.  
**MAX. TEMPERATURE** : 70°C  
**MIN. LIQUID SP. GR..** : 0.8  
**WEIGHT (APPROX)** : 25 gms.  
**DIFFERENTIAL** : 3-5mm

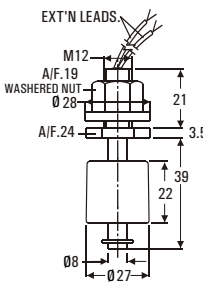

**MODEL No.** : MFGS-G58  
**FLOAT MATERIAL** : GLASS FILLED NYLON  
**FLOAT SIZE** : Ø27x22mm.  
**GUIDE TUBE MATERIAL** : GLASS FILLED NYLON  
**PROCESS CONN.** : M12 (Screwed) with nut  
**SWITCH CAPACITY** : 10VA(N/O)  
**SWITCHING VOLTAGE** : 140VAC/200VDC  
**SWITCHING CURRENT** : 0.5A  
**CARRY CURRENT** : 3A  
**TERMINATION** : PVCx1Mtr extn leads  
**SWITCH ACTION** : REVERSIBLE  
**MAX. TEST PRESSURE** : 1Kg/cm2.  
**MAX. TEMPERATURE** : 80°C  
**MIN. LIQUID SP. GR..** : 0.8  
**WEIGHT (APPROX)** : 38 gms.  
**DIFFERENTIAL** : 3-5mm

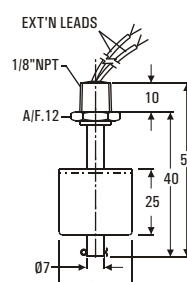

**MODEL No.** : MFGS-Q24  
**FLOAT MATERIAL** : PP(HOLLOW)  
**FLOAT SIZE** : Ø25x25mm.  
**GUIDE TUBE MATERIAL** : BRASS  
**PROCESS CONN.** : 1/8" NPT.  
**SWITCH CAPACITY** : 10VA or 40VA(N/O)  
**SWITCHING VOLTAGE** : 240VAC/200VDC  
**SWITCHING CURRENT** : 2A  
**CARRY CURRENT** : 3A  
**TERMINATION** : PVCx300mm.extn leads  
**SWITCH ACTION** : REVERSIBLE  
**MAX. TEST PRESSURE** : 1Kg/cm2.  
**MAX. TEMPERATURE** : 70°C  
**MIN. LIQUID SP. GR..** : 0.75  
**WEIGHT (APPROX)** : 30 gms.  
**DIFFERENTIAL** : 3-5mm

## MFGS

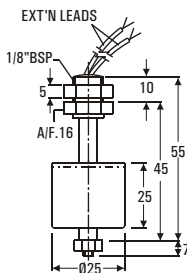

**MODEL No.** : MFGS-Q21  
**FLOAT MATERIAL** : PP(HOLLOW)  
**FLOAT SIZE** : Ø25x25mm.  
**GUIDE TUBE MATERIAL** : PP  
**PROCESS CONN.** : 1/8" BSP. with lock nut  
**SWITCH CAPACITY** : 10VA or 40VA(N/O)  
**SWITCHING VOLTAGE** : 240VAC/200VDC  
**SWITCHING CURRENT** : 2A  
**CARRY CURRENT** : 3A  
**TERMINATION** : PVCx300mm.extn leads  
**SWITCH ACTION** : REVERSIBLE  
**MAX. TEST PRESSURE** : 1Kg/cm2.  
**MAX. TEMPERATURE** : 70°C  
**MIN. LIQUID SP. GR..** : 0.75  
**WEIGHT (APPROX)** : 25 gms.  
**DIFFERENTIAL** : 3-5mm

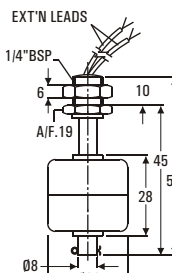

**MODEL No.** : MFGS-N32  
**FLOAT MATERIAL** : SS304  
**FLOAT SIZE** : Ø28x28mm.  
**GUIDE TUBE MATERIAL** : SS304  
**PROCESS CONN.** : 1/4" BSP. with lock nut  
**SWITCH CAPACITY** : 10VA or 40VA(N/O)  
**SWITCHING VOLTAGE** : 240VAC/200VDC  
**SWITCHING CURRENT** : 2A  
**CARRY CURRENT** : 3A  
**TERMINATION** : PTFEx300mm.extn leads  
**SWITCH ACTION** : REVERSIBLE  
**MAX. TEST PRESSURE** : 5Kg/cm2.  
**MAX. TEMPERATURE** : 100°C  
**MIN. LIQUID SP. GR..** : 0.8  
**WEIGHT (APPROX)** : 55 gms.  
**DIFFERENTIAL** : 3-5mm

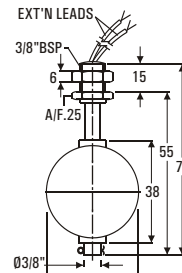

**MODEL No.** : MFGS-S43  
**FLOAT MATERIAL** : SS316  
**FLOAT SIZE** : Ø41x38mm.  
**GUIDE TUBE MATERIAL** : SS316  
**PROCESS CONN.** : 3/8" BSP. with lock nut  
**SWITCH CAPACITY** : 10VA or 40VA(N/O)  
**SWITCHING VOLTAGE** : 240VAC/200VDC  
**SWITCHING CURRENT** : 2A  
**CARRY CURRENT** : 3A  
**TERMINATION** : PTFEx300mm.extn leads  
**SWITCH ACTION** : REVERSIBLE  
**MAX. TEST PRESSURE** : 5Kg/cm2.  
**MAX. TEMPERATURE** : 150°C  
**MIN. LIQUID SP. GR..** : 0.7  
**WEIGHT (APPROX)** : 100 gms.  
**DIFFERENTIAL** : 3-5mm

NOTE : MODIFIED MODEL MFGS-S43 ALSO AVAILABLE WITH 60VA(C/O) REED CONTACT

### PUNE TECHTROL PVT. LTD.

We reserve the right to modify design and specifications without prior notice.

**WORKS**

'S' 18, MIDC, Bhosari, Pune : 411026 India  
 Tel +91-20-27129298, 27121052, 27128055, 56111996/7  
 Fax +91-20-27121663  
 E mail : techtrol@pn2.vsnl.net.in  
 Web : www.punetechtrol.com

**SERVICE CENTRE**

20/21, Parshwanath Indl.  
 Co-op. Society,  
 Bhosari, Pune - 411026  
 India  
 Tel : +91-20-56113565

NOTE: ALL DIMENSIONS ARE IN mm. EXCEPT SPECIFIED.

50-20/04/Rev-2/10000/CAT

## FLOAT OPERATED, MINI LEVEL SWITCHES 'MFPS'

**MINI LEVEL SWITCHES -'MFPS'** : Are installed horizontally, and can be mounted vertically for some application like flow detection. They provide actuations at high, low or intermediate liquid levels and the switch action can be reversed by reorientation of mounting, so that "it closes" on rising liquid levels (N/O) or on falling liquid level (N/C).

**APPLICATIONS** : Hot Water / Coffee Servers, Vending Machines, Ice Makers, Humidifiers, Food Industry, Air Conditioning & Refrigeration, Analysers, Engines, Agricultural Machines, Hydraulic, Lubricating & Oil Filtration Equipment's, Industrial Working Machines, & SPMs.

### INSTALLATION

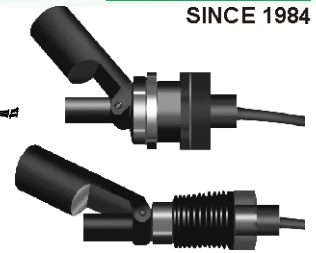
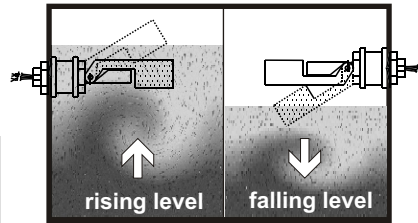

## MFPS

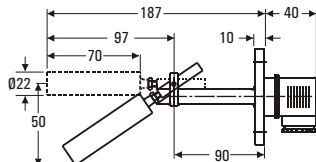

**MODEL NO.** : MFPS-N26  
**FLOAT MATERIAL** : SS304  
**FLOAT SIZE** : Ø22x70mm.  
**TRIM MATERIAL** : SS304  
**PROCESS CONN.** : 52SQ.xPCD54, 4HxØ5 FLANGE  
**SWITCH CAPACITY** : 10VA or 40VA(N/O)  
**SWITCHING VOLTAGE** : 240VAC/200VDC  
**SWITCHING CURRENT** : 2A  
**CARRY CURRENT** : 3A  
**TERMINATION** : PLUG IN CONN.  
**SWITCH ACTION** : REVERSIBLE  
**MAX. TEST PRESSURE** : 5Kg/cm<sup>2</sup>.  
**MAX. TEMPERATURE** : 150°C  
**MIN. LIQUID SP. GR.** : 1.0  
**WEIGHT (APPROX)** : 315 gms.  
**DIFFERENTIAL** : 3-5mm

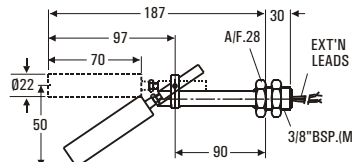

**MODEL NO.** : MFPS-N23  
**FLOAT MATERIAL** : SS304  
**FLOAT SIZE** : Ø22x70mm.  
**TRIM MATERIAL** : SS304  
**PROCESS CONN.** : 3/8" BSP.(M)  
**SWITCH CAPACITY** : 10VA or 40VA(N/O)  
**SWITCHING VOLTAGE** : 240VAC/200VDC  
**SWITCHING CURRENT** : 2A  
**CARRY CURRENT** : 3A  
**TERMINATION** : PVCx300mm. extn. leads  
**SWITCH ACTION** : REVERSIBLE  
**MAX. TEST PRESSURE** : 5Kg/cm<sup>2</sup>.  
**MAX. TEMPERATURE** : 150°C  
**MIN. LIQUID SP. GR.** : 1.0  
**WEIGHT (APPROX)** : 210 gms.  
**DIFFERENTIAL** : 3-5mm

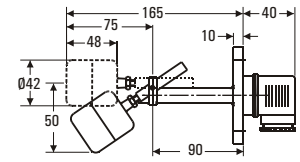

**MODEL NO.** : MFPS-N47  
**FLOAT MATERIAL** : SS304  
**FLOAT SIZE** : Ø42x48mm.  
**TRIM MATERIAL** : SS304  
**PROCESS CONN.** : 75SQ.xPCD75, 4HxØ10 FLANGE  
**SWITCH CAPACITY** : 10VA or 40VA(N/O)  
**SWITCHING VOLTAGE** : 240VAC/200VDC  
**SWITCHING CURRENT** : 2A  
**CARRY CURRENT** : 3A  
**TERMINATION** : PLUG IN CONN.  
**SWITCH ACTION** : REVERSIBLE  
**MAX. TEST PRESSURE** : 5Kg/cm<sup>2</sup>.  
**MAX. TEMPERATURE** : 150°C  
**MIN. LIQUID SP. GR.** : 0.8  
**WEIGHT (APPROX)** : 525 gms.  
**DIFFERENTIAL** : 3-5mm

## MFPS

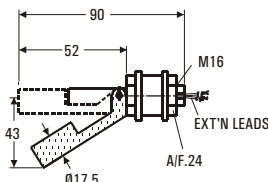

**MODEL NO.** : MFPS-Q12  
**FLOAT MATERIAL** : PP(HOLLOW)  
**FLOAT SIZE** : Ø17x52mm.  
**TRIM MATERIAL** : PP  
**PROCESS CONN.** : M16 with Lock Nut  
**SWITCH CAPACITY** : 50VA(N/O)  
**SWITCHING VOLTAGE** : 240VAC/200VDC  
**SWITCHING CURRENT** : 1A  
**CARRY CURRENT** : 0.5A  
**TERMINATION** : PVCx300mm. extn. leads  
**SWITCH ACTION** : REVERSIBLE  
**MAX. TEST PRESSURE** : 1Kg/cm<sup>2</sup>.  
**MAX. TEMPERATURE** : 70°C  
**MIN. LIQUID SP. GR.** : 0.7  
**WEIGHT (APPROX)** : 35 gms.  
**DIFFERENTIAL** : 3-5mm

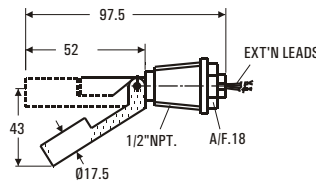

**MODEL NO.** : MFPS-Q15  
**FLOAT MATERIAL** : PP(HOLLOW)  
**FLOAT SIZE** : Ø17.5x52mm.  
**TRIM MATERIAL** : PP  
**PROCESS CONN.** : 1/2" NPT  
**SWITCH CAPACITY** : 50VA(N/O)  
**SWITCHING VOLTAGE** : 240VAC/200VDC  
**SWITCHING CURRENT** : 1A  
**CARRY CURRENT** : 0.5A  
**TERMINATION** : PVCx300mm. extn. leads  
**SWITCH ACTION** : REVERSIBLE  
**MAX. TEST PRESSURE** : 1Kg/cm<sup>2</sup>.  
**MAX. TEMPERATURE** : 70°C  
**MIN. LIQUID SP. GR.** : 0.7  
**WEIGHT (APPROX)** : 20 gms.  
**DIFFERENTIAL** : 3-5mm

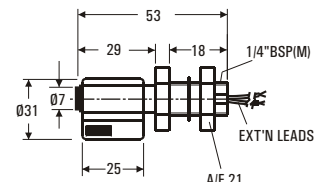

**MODEL NO.** : MFPS-P32  
**FLOAT MATERIAL** : PP(SOLID)  
**FLOAT SIZE** : Ø31x25mm.  
**TRIM MATERIAL** : PP  
**PROCESS CONN.** : 1/4" BSP  
**SWITCH CAPACITY** : 50VA(N/O)  
**SWITCHING VOLTAGE** : 240VAC/200VDC  
**SWITCHING CURRENT** : 1A  
**CARRY CURRENT** : 0.5A  
**TERMINATION** : PVCx300mm. extn. leads  
**SWITCH ACTION** : REVERSIBLE  
**MAX. TEST PRESSURE** : ATM  
**MAX. TEMPERATURE** : 70°C  
**MIN. LIQUID SP. GR.** : 0.7  
**WEIGHT (APPROX)** : 20 gms.  
**DIFFERENTIAL** : 3-5mm

NOTE - MODIFIED MODELS MFPS-N26, N23 & N47 ALSO AVAILABLE WITH GOUVAC(D) REED CONTACT

## 'FREE FALL FLOAT' OPERATED, MINI LEVEL SWITCH 'MFFPS' FOR LIQUIDS

## MFFPS

Is similar to 'MFPS' and installed horizontally, except for specially designed free fall float, which is always uniquely positioned on the switch enclosure to overcome inhibition of float movement due to build-up of magnetic particles, limescale etc. around the pivot, normally encountered in conventional MFPS model. The construction of 'MFFPS' always positions the magnet carrying float trim, switch enclosure and pivot above the liquid surface to provide normally closed contacts (NC), which open on rising liquid level.

**MODEL NO.** : MFFPS-Q52  
**FLOAT MATERIAL** : PP(HOLLOW)  
**FLOAT SIZE** : Ø27x24mm.  
**TRIM MATERIAL** : PP  
**PROCESS CONN.** : M16  
**SWITCH CAPACITY** : 40VA(N/C)  
**SWITCHING VOLTAGE** : 230VAC/DC  
**SWITCHING CURRENT** : 2AMP  
**CARRY CURRENT** : 3AMP  
**TERMINATION** : PVCx300mm. extn. leads  
**SWITCH ACTION** : NON REVERSIBLE  
**MAX. TEST PRESSURE** : 1Kg/cm<sup>2</sup>.  
**MAX. TEMPERATURE** : 70°C  
**MIN. LIQUID SP. GR.** : 0.7  
**WEIGHT (APPROX)** : 25 gms.  
**DIFFERENTIAL** : 5-8mm

