

Diaphragm-Type Chemical Seals

Flange-Type Seals with Extended Diaphragm • Model 990.29

Chemical Seals

Service intended

Process industry chemical seal to combine with pressure transmitters and pressure gauges. Design enables flush installation at heavily insulated vessels. Suitable for corrosive, contaminated, hot or viscous pressure media.

Design

Flange with diaphragm extension

Process connection

Flanges DN 50 to DN 125 (2 to 5 in.) per DIN, ANSI or other standards.

Pressure rating

PN 16 to PN 40/50 (class 150 to 300)

Suitable pressure ranges

25 mbar and up, depending on diaphragm size and process conditions.



Standard features

Body

Stainless steel 1.4571 to accept capillary extension.

Diaphragm inclusive extension and sealing face

Stainless steel 1.4571, welded with body.

Process connection

Flange DIN 2501, sealing face form D DIN 2526

Diaphragm extension

50, 100, 150 or 200 mm

Capillary extension

Centre-axial entry armoured capillary of stainless steel 1.4571, welded to body.

Standard extension 1, 1.6, 2.5, 4, 6, 8, 10, 15 m

Minimum curve radius 50 mm

Armour material stainless steel 1.4301

Instrument connection

Adaptor G ½ female per EN 837-1 /7.3.5, welded to capillary

Material stainless steel 1.4571

Installation

Use appropriate gasket per DIN 2690 or ANSI B 16.5 (gasket not inclusive)

Optional extras

Body

- Stainless steel 1.4404, 1.4435, 1.4541, titanium
- Flame proof throttle approved for Zone 0

Diaphragm inclusive extension and sealing face

- Stainless steel 1.4404, 1.4435, 1.4541, titanium
- Foil jacket of Hastelloy B2, C4, C276, Monel 400, Nickel, tantalum
- 25 micron gold plating
- PFA coating max. 260 °C
- ECTFE coating max. 150 °C

Process connection

- Flanges per DIN, ANSI or other standards, maximum size DN 125 (5 in.)
- Optional sealing faces (with foiljacket non-serrated (smooth) finish only)

Diaphragm extension

- Custom lengths available

Capillary extension

- Custom length extension (min. 1, max. 15 m)
- Soft polyethylene armour

Instrument connection

- Adaptor with optional welding or pipe thread nipple
- Gauge adaptor G ½ female for directly mounted gauge
- Various adaptors for directly mounted transmitters
- Cooling tower for directly mounted gauge when medium temperature > +100 °C

Dimensions
Standard version

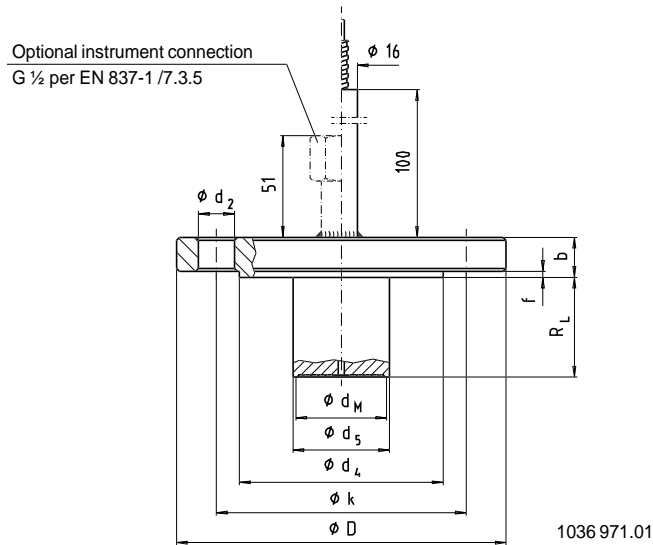

Flange per DIN 2501

DN [mm]	PN [bar]	Dimensions [mm]									
		d _M	D	b	No. of bolt holes	d ₂	k	Raised portion		Extension	
								f	d ₄	d ₅	R _L
50	40	47	165	20	4	18	125	3	102	48.3	50, 100, 150, 200
80	16	72	200	20	8	18	160	3	138	76	50, 100, 150, 200
	40	72	200	24	8	18	160	3	138	76	50, 100, 150, 200
100	16	89	220	20	8	18	180	3	158	94	50, 100, 150, 200
	40	89	235	24	8	22	190	3	162	94	50, 100, 150, 200
125	16	124	250	22	8	18	210	3	188	125	50, 100, 150, 200
	40	124	270	26	8	26	220	3	188	125	50, 100, 150, 200

Flange per ANSI B 16.5

DN [in.]	Class	Dimensions [mm]									
		d _M	D	b	No. of bolt holes	d ₂	k	Raised portion		Extension	
								f	d ₄	d ₅	R _L
2	300	47	165	22.5	8	20	127	1.6	92	48.3	50, 100, 150, 200
3	150	72	190	24	4	20	152.5	1.6	127	76	50, 100, 150, 200
	300	72	210	29	8	22	168.5	1.6	127	76	50, 100, 150, 200
4	150	89	230	24	8	20	190.5	1.6	158	94	50, 100, 150, 200
	300	89	255	32	8	22	200	1.6	158	94	50, 100, 150, 200

Effective diameter of diaphragm = d_M

Ordering information

Specify:

Model / Size, pressure rating and applicable standard of connection / Material of wetted parts / Extension / Size of instrument connection / Filling liquid / Pressure instrument desired / Process conditions as per questionnaire / Optional extras required

Specifications and dimensions given in this leaflet represent the state of engineering at the time of printing. Modifications may take place and materials specified may be replaced by others without prior notice.



WIKA Alexander Wiegand GmbH & Co.
Alexander-Wiegand-Straße · 63911 Klingenberg
☎ (0 9372) 132-0 · ☎ (0 9372) 132-406/414
http://www.wika.de · E-mail: info@wika.de